

STIRLING[®]

STEAM MOP WITH DETERGENT DISPENSER

Dual tank operation
Detergent release control



Features:



Steam Trigger

Integrated into handle for easy use



30 Second Heat-Up

Fast heat-up time for steam production



650mL Water Capacity

For thorough steam cleaning of hard floors and carpets



200mL Detergent Tank

Holds detergent solution for hard floor cleaning

Quick Start Guide

This Quick Start Guide only contains basic information. Please read the full manual for comprehensive instructions and safety advice before first use. The relevant sections in the manual are listed in brackets below.

Carpet and hard floor steam cleaning

Step 1

Attach the steam mop head and handle to the steam mop body as per instruction manual (page 9).

Step 2

Remove the water tank from the back of the unit, fill it with 500mL of tap water and reattach (page 10).

Step 3

Fasten a cleaning pad to the base of the steam mop and ensure the solution tank dial is set to CLOSE (page 12).

Step 4

The steam mop is now ready for use on sealed hard floors. To use it on carpet, place the mop head into the carpet glider for better manoeuvrability (page 13).

Step 5

Press the ON/OFF switch to turn on the steam mop. Place your foot over the shoe symbol on the mop head and gently pull the handle downwards to recline it, then pull the trigger on the handle to release the steam while moving the mop backwards and forwards (page 12).

Step 6

If you want to clean hard floors with the detergent solution, switch off the unit. Remove the solution tank from the front of the unit, fill it with a maximum 180mL POWERFORCE Steam Mop Solution and reattach (page 11). Then turn the solution tank dial to OPEN for maximum solution delivery. (You may turn it clockwise towards the CLOSE position to decrease the amount of solution.) Switch on the unit and when the ready indicator illuminates, proceed as above.

IMPORTANT: Do not use detergent solution on carpet. Test the solution in an inconspicuous area before using it on a suitable hard floor.

CAUTION: To avoid scalding and burns, take extra care when using the steam mop. Never point the mop at persons, pets or plants, and only use it on surfaces that can withstand high heat.

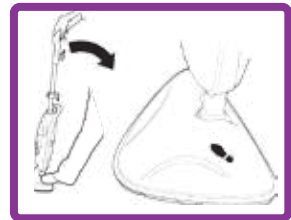
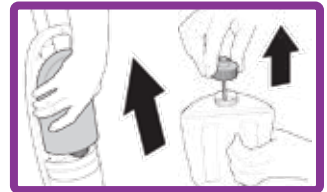
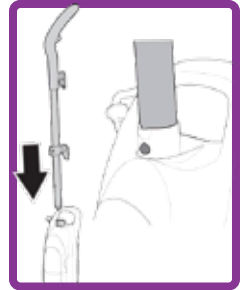

Model Number	SC270S
Colour	White and Blue
Power	1400W-1600W
Warranty	3 Years
Version	QSG-V1.2

For more information please visit www.stirlingappliances.com.au or call 1300 886 649